



ROAD DRIVE WAY SLAB

PRODUCT SPECS

Mass-produced with vibrated concrete with minimum compressive strength class C32/40 (ex Rck 40 N/mm²) composed of: carefully selected quarry aggregates, high-strength cement in CEM II/A-LL 42.5 R classes compliant UNI EN 197-1, they constitute a "dry" mix with low workability (Slump flow S1/S2).

The reinforcement is made of drawn B450A steel adequately calculated based on normal conditions of use.

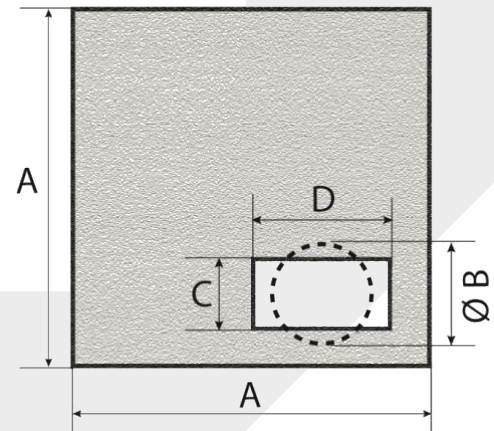

PRODUCT CODE	DESCRIPTION	PRODUCT SIZE (CM)					WEIGHT (KG)
		A	B	C	D	H	
233/A	ROAD DRIVE WAY SLAB	100	60	50	70	20	370
233	ROAD DRIVE WAY SLAB	120	60	50	70	20	500
235	ROAD DRIVE WAY SLAB	140	60	50	70	20	790
234	ROAD DRIVE WAY SLAB	180	60	50	70	20	1350

Please note that, upon request, slabs can be made to measure, with variable dimensions, reinforcements and holes according to the operating load used.