



DRILLED CLOSED CONCRETE MANHOLE COVER

PRODUCT SPECS

Mass-produced with vibrated concrete having a resistance ≥ 40 Mpa composed of: carefully selected quarry aggregates, Portland cement with limestone type II A-LL 42.5 R UNI EN 197-1, they make up a "dry" mix with a W/C ratio = $0.40 \div 0.50$.

The reinforcement is made up of FeB44K electro-welded mesh adequately calculated on the basis of normal conditions of use.

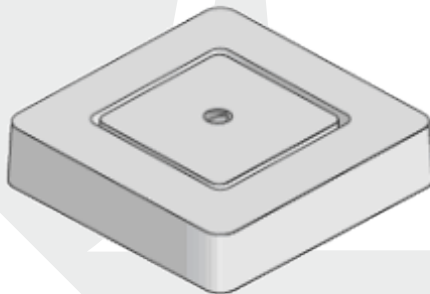

TECHNICAL DATA

PRODUCT CODE	DESCRIPTION	EXTERNAL MEASURE (cm)	INTERNAL MEASURE (cm)	HEIGHT (cm)	WEIGHT (kg)	PIECES PER PALLET
261	CLOSED MANHOLE	30x30	18x18	5	8	96
262	CLOSED MANHOLE	40x40	24x24	7	20	54
263	CLOSED MANHOLE	50x50	31x31	8	36	24
264	CLOSED MANHOLE	60x60	37x37	9	60	24
265	CLOSED MANHOLE	70x70	47x47	18	92	5
241	DRILLED MANHOLE	30x30	18x18	5	7	60
242	DRILLED MANHOLE	40x40	24x24	7	18	45
243	DRILLED MANHOLE	50x50	31x31	8	32	28
244	DRILLED MANHOLE	60x60	37x37	9	55	24